

Telecoms Newsletter – Q2 2026

Marking 35 years within the Haley Group as the Group celebrates its 40th anniversary.

This year, FLI proudly celebrates 35 years as part of the Haley Group, alongside the Haley Group's 40th anniversary.

Over the past three and a half decades, FLI has built a reputation for providing innovative engineered and practical solutions, in terms of GDC's, Towers, Monopoles, Headframes, ButterFLI's, Tree Masts, Screw Pile Foundations and associated steelwork. We'd like say "thank you", to all of our telecoms customers, for your support and working with us over the years.

As we celebrate this milestone, we recognise the people, customers and partners who have been part of the journey and look forward to working with you in the coming years.

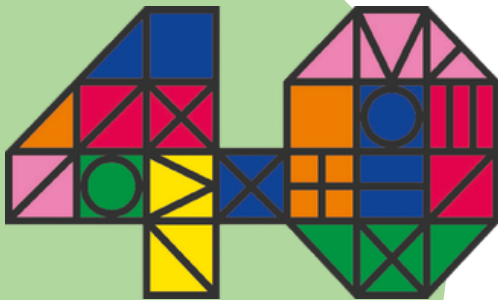

40 years of the Haley Group

Industry Recognition: FLI Wins at the Cornerstone Awards

FLI Structures is proud to have won the **Innovation in Tower Infrastructure Supply Chain Award** at the inaugural **Cornerstone Supplier Awards 2026**.

The award recognises our expertise in delivering innovative telecoms infrastructure solutions, from towers and strengthening works to foundation upgrades and temporary sites.

A huge thank you to the team for their hard work and dedication, and congratulations to all the award winners and nominees.

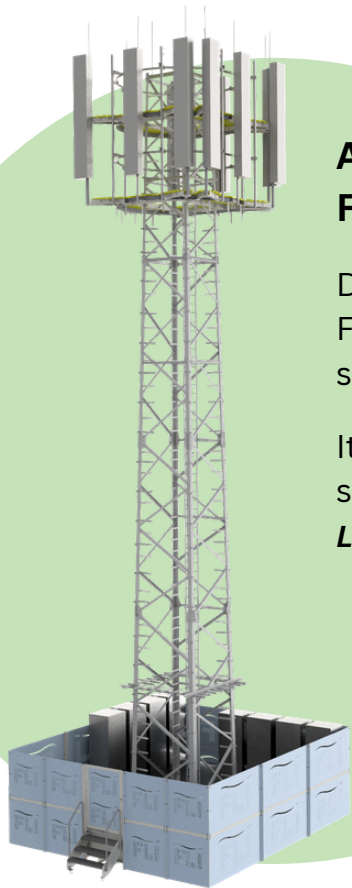

At the heart of our Cornerstone Awards submission was FLItempo, our patent-pending Kentledge Base Temporary Tower.

Designed to meet the demands of the music and sports event industries, FLItempo offers a rapid-deployment, highly reliable and cost-effective mast solution.

Its innovative design enables fast installation while maintaining the strength, stability and performance required in challenging event environments.

Learn more: [FLI's Temporary Towers](#)

Resources for You

Our full range of Monopole, Streetworks Poles and Lattice Tower Foundation design reports are available via email and on our website. Click [here](#) to see more [FLI's Downloadable Resources](#)



Tower Strengthening: Engineering Beyond the Analysis

Tower strengthening demands more than structural analysis. With decades of experience across telecoms infrastructure, FLI identifies critical capacity constraints and delivers practical, cost-effective strengthening solutions that extend asset life, maximise loading potential, and avoid unnecessary tower replacement.

Assessing Structural Capacity

FLI's GDC assessment tool identifies capacity constraints and pinpoints areas requiring strengthening, enabling targeted and cost-effective interventions. Visit [FLI's GDC Portal](#) for more.

Tower Strengthening Solutions

For lattice towers and monopoles, FLI designs strengthening solutions for legs, braces, and headframes, increasing structural capacity and extending asset life while helping operators avoid the costs associated with tower replacement.

Patented Base Strengthening with ButterFLI

Corrosion at the tower-to-foundation interface can threaten the integrity of an entire structure. FLI's patented ButterFLI system is the industry's only proven solution for strengthening corroded tower foundation connections, restoring structural capacity without excavation, heavy plant, or tower replacement.

Headframe Strengthening

As modern 4G and 5G equipment places greater demands on ageing structures, headframes can become overstressed or exceed deflection limits. FLI designs bespoke strengthening solutions that increase capacity, improve stiffness, and enable continued asset utilisation without the need for major replacement works.

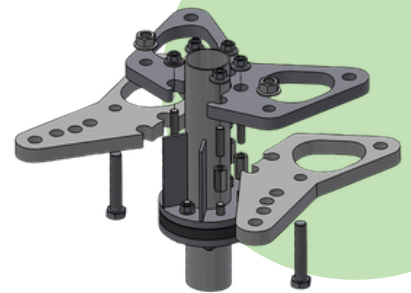

Innovation Update: New Pile Design Tool Ready for Launch

FLI has launched its new **Online Screw Pile Design Portal**, giving engineers and contractors instant access to tailored screw pile foundation designs and budget estimates.

Designed to streamline the early stages of project planning, the portal allows users to upload site data, enter load requirements and receive an engineered foundation solution within minutes – without the need for a formal enquiry.

Key features:

- Instant foundation feasibility assessments.
- Tailored screw pile designs in minutes.
- Engineered solutions based on project inputs.
- Immediate budget cost estimates.
- Reduced design and procurement delays.
- Faster, more informed project decisions.



“The FLI Design Tool streamlines complex engineering calculations, ensuring precision and efficiency in every project. A game-changer for structural design.”

Register at

<https://flipiledesign.co.uk/>

Upload your site requirements.

Design your foundation solution
and receive a tailored quote.



Our GDC Portal has also undergone some updates!

Pricing updates and streamlined processes to the GDC form now allow you to upload your site number and track your projects more easily than ever.

Learn more: View our GDC Portal and get your project started
<https://www.fli.co.uk/markets/telecoms/global-design-check/>

Project Spotlight: Bob Shaw Bridge Grand Opening

FLI has completed the design, fabrication and installation of the new Bob Shaw Bridge in Loxton, Somerset.

Donated by the Haley Group and commissioned by the Frankie Howerd OBE Trust, the bridge provides safer access between the village car park and the Frankie Howerd Community Hub & Café.

Officially opened by Dame Joanna Lumley, the bridge combines accessibility, durability and local character within the Mendip Hills landscape.

Project Highlights

- Demonstrating FLI's social value, to a worthwhile local community project
- Installed in just one day
- Durable, non-slip modular decking
- Improved accessibility for local residents
- Designed to complement the surrounding landscape

Learn more: Read the full story

[Bob Shaw Footbridge Case Study](#)



Nick Goodman
Towers & Radar

nickg@fli.co.uk
07790 103 747

Tony Parker
Sales Manager

tonyp@fli.co.uk
07738 623 487

Oscar Newman
Rail

oscarn@fli.co.uk
07889 087 272

Rob Skone
Foundations & Bridges

robs@fli.co.uk
07710 043 396

Ella Wells
General Enquiries & Marketing

ellaw@fli.co.uk
07711 982556